

**BEECH FOREST DETAIL**  
Plan - Scale 1:1,000

- LEGEND**
- Existing building.
  - Property title boundary.
  - Existing powerlines.
  - Existing river / watercourse.
  - Existing vegetation.
  - Proposed exotic trees.
  - Proposed indigenous tree & shrub planting.
  - Proposed pathway (varied surfaces and widths).
  - Original Beechy Line alignment
  - Proposed seating.
  - Proposed picnic table & seating.
  - Proposed BBQ.
  - Proposed bollards.
  - Proposed playground.
  - Proposed interpretative signage.

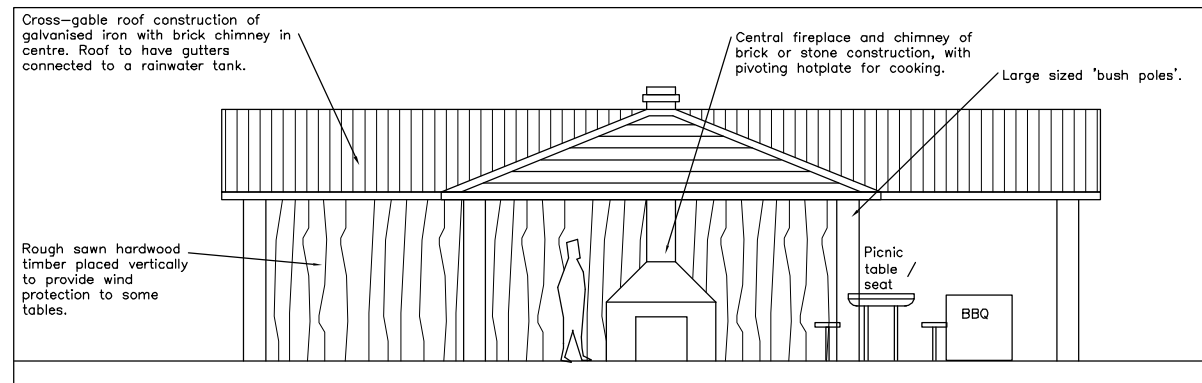

**LARGE SHELTER - JOHN H. GARDNER RESERVE**  
Front Elevation - Scale 1:50

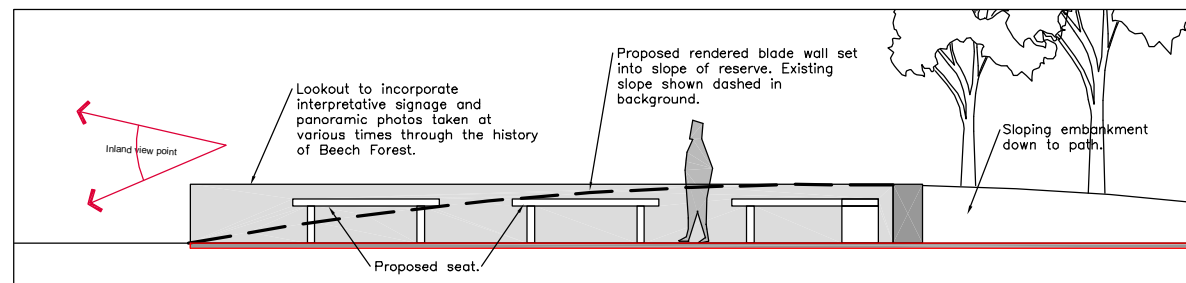

**LOOKOUT - JOHN H. GARDNER RESERVE**  
Side Elevation - Scale 1:50

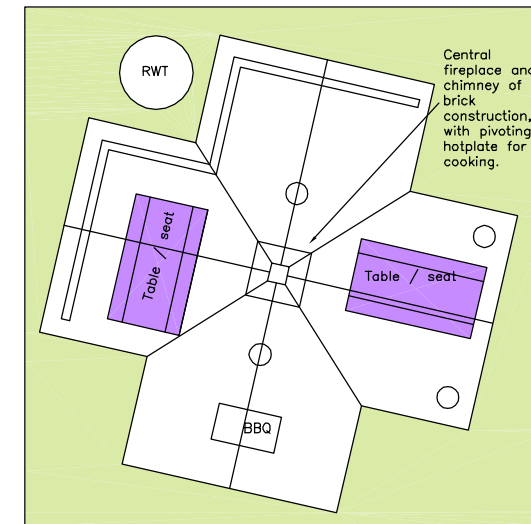

**LARGE SHELTER - JOHN H. GARDNER RESERVE**  
Plan - Scale 1:100

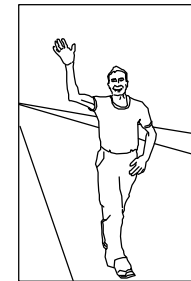

Proposed life-size bronze (or similar medium) statue created as a memorial to Cliff Young. Sculpture to be placed on a 1 metre wide winding asphalt track (as shown on plan) which evokes an image of the highway.

**CLIFF YOUNG MEMORIAL SCULPTURE**  
Elevation - Not to Scale

**NOTES:**  
 Base information derived from  
 - aerial photograph (dated April 13, 1997)  
 - site visits  
 - Colac Otway Shire cadastral information

Due to possible photographic distortions the location of all existing features is approximate only. The location of existing features in the vicinity of proposed development works should be confirmed on site prior to the commencement of works.

Date: November 2003  
 Scale: As shown  
 Designed: DH / JS  
 Drawing No: 03085 - 02

# BEECH FOREST TOWNSHIP

**Details Plan**  
 URBAN DESIGN ADVICE - NOVEMBER 2003

